

Mtandire Community Education Empowerment Project, Malawi





- There is a lack of opportunities for children in Malawi.

In 2015, the World Bank declared Malawi the poorest country in the world per capita.

Mtandire, Lilongwe, Malawi is the largest inner city township in the country and is known as 'the ghetto'.

It is chronically underserved.

*Give a child a football
And watch them go and play
See their smiling faces
Embracing each new day*

*Give every single child the
chance
To live and learn and grow
It starts from one small thing
in life
The seed of hope we sow*

*To build a generation
Of people who inspire
Lingadzi has the time and
space
To teach, to dream, aspire*

- Mark Howell

**Building
Malawi**

A little help goes a long way.

Rotary Clubs from across the globe are working together to raise \$15,000USD for the Mtandire Community Education Empowerment Project, Malawi. This will be matched regionally to achieve \$30,000USD and then doubled through the international grant system.



Josephy Chavula

Rotary Club of Bwaila,
Lilongwe, Malawi

\$500USD



Mark Howell

Rotary Club of Colchester
Centurion, UK

\$6250USD



Graeme Howell

Rotary Club of Shousan Hill, Hong Kong for The
Affordable Classroom Construction Project



Jacky Bertrand

Rotary Club of Tours
Val de Loire, France

\$1000USD



We have \$8750USD of our \$15000USD target. Can your club make a contribution to this project?

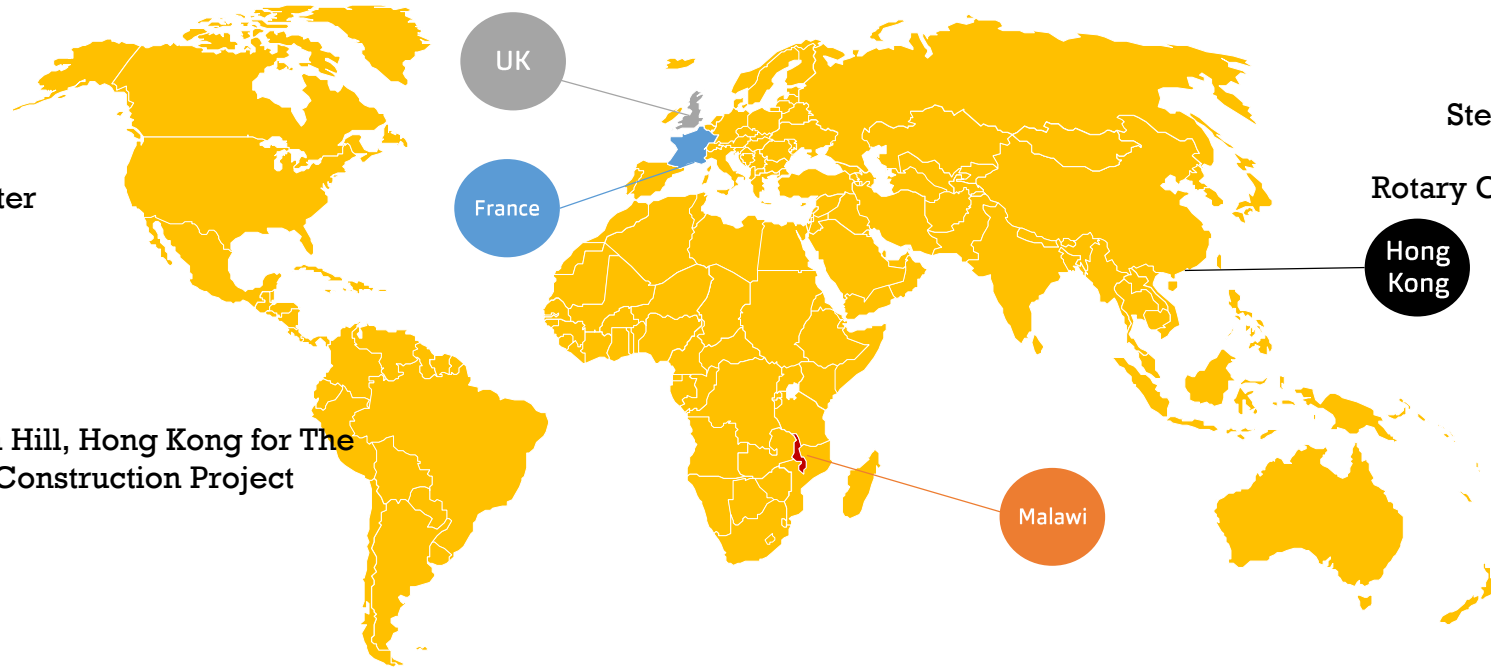

Ed Alexander

North Cotswold Rotary, UK

\$500USD

Steve Higgingbotham

Rotary Club of Royston, UK

\$500USD



Responding to needs defined by Malawi Government and the Mtandire community

The Malawi Government Growth and Development Strategy (MGDS III) states that there are:

"inadequate and inferior physical learning infrastructures"

And that there is the need to:

"increase empowerment among all Malawians especially the disadvantaged"

"prepare young men and women for productive employment within and outside Malawi"

The Lingadzi Academy Education Empowerment Project responds directly to these needs.



Teamwork makes the dream work

The Mtandire Community Education Empowerment Project will mobilise \$60,000 USD of Rotary funding to support the work of the following partners:



The Malawi National Library Service (Malawi Government) will run adult literacy education.



Zikomo Foundation (Switzerland) will run a primary school.



Ascent Soccer (USA) will upskill coaches & community captains in collaboration with Tackle Africa to deliver sexual health through football.



WICEM (Malawi) - Widows Care & Empowerment Ministry – Will support widows and vulnerable group live a healthy productive and purposeful life.



Tingathe (Malawi) will operate workshops to support the youth to become entrepreneurs and professionals.





What is Lingadzi Academy?

Lingadzi Academy is a 22 acre site in the bustling township of Mtandire in the capital of Malawi, Lilongwe.

It is a place to learn, play, grow and come together. A place where young Malawians are provided the opportunity to fulfil their potential.

It consists of 5 football pitches, 1 hard court netball court, a library and a police station.

It is a platform that meets the changing needs in the area from which multiple organisations can operate to support the community.

Over 500 young people use the site every day to play sport, meet their friends and use the library. Demand for further educational opportunities is high and many established agencies are keen to do more in this township.

We aim to meet this demand by improving the facilities and welcoming more delivery partners to use the site.

Your support will make this happen.

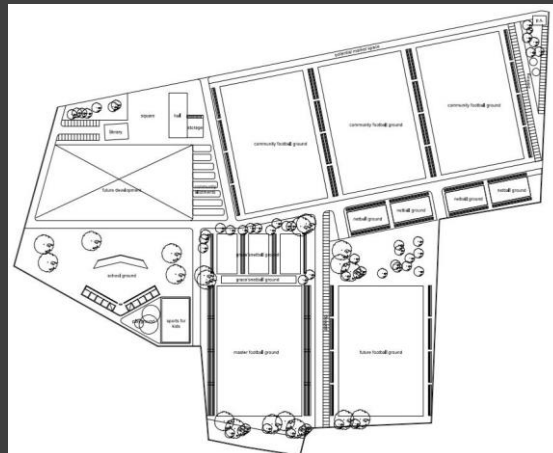

“Give a man a fish and you feed him for a day; teach a man to fish and you feed him for a lifetime”

The Lingadzi Academy Community Education Empowerment Project will invest the \$60,000 USD of Rotary funding to provide:

\$45,000 4 x multi-use earthbag community educational facilities

and

\$15,000 Start up funding for primary school, adult literacy, youth entrepreneurship and establishment of a kitchen garden as well as vocational training for existing football coaches to equip them with a health curriculum.

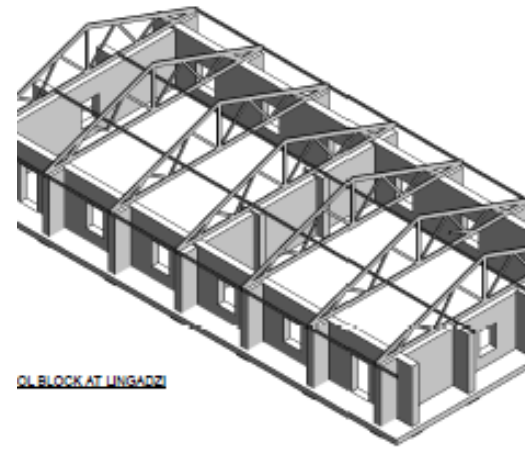

Please contact us if you can help



Mark Howell (IPP)

Rotary Club of Colchester Centurion, UK

markanddiana@virginmedia.com

I love collaborative projects and think this is where Rotary is at its brilliant best. With just a few small contributions from lots of different clubs we shall be able to achieve something which will have a huge impact for many young people in Malawi.

So, please make any contribution you can. Large or small.

When the target is hit we shall complete the grant application and the final funds will be distributed through Rotary Bwaila, Lilongwe, Malawi.

Of course, if you have any questions please do not hesitate to get in touch.

Thank you for your consideration,

Mark





**Zikomo
Kwambiri!**

**Thank
you!**

**BUILDING
MALAWI**